



US Army Corps  
of Engineers  
Seattle District

# Public Notice of Application for Permit

US Army Corps of Engineers  
Regulatory Branch  
4735 E. Marginal Way S., Bldg  
1202  
Seattle, WA 98134-2388  
Telephone: (206) 764-5527  
ATTN: Trevor Williams,  
Project Manager

Public Notice Date: February 14, 2025  
Expiration Date: March 16, 2025

Reference No.: NWS-2023-705  
Name: Washington, University of  
(WAC & Husky Harbor Dock  
Improvements)

---

Interested parties are hereby notified that an application has been received for a Department of the Army permit in accordance with Section 10 of the Rivers and Harbors Act of 1899, for certain work described below and shown on the enclosed drawings dated August 31, 2024.

The Corps will also review the work in accordance with Section 404 of the Clean Water Act (CWA).

The Corps will also review the work in accordance with Section 14 of the Rivers and Harbors Act of 1899, as codified at 33 U.S.C. Section 408 (Section 408), for work that may alter a Corps Civil Works project. An alteration is defined as any action that builds upon, alters, improves, moves, occupies or otherwise affects the usefulness, or the structural or ecological integrity of a Corps federally authorized project. The proposed project may alter the Lake Washington Ship Canal.

APPLICANT: University of Washington  
Attention: Ms. Anna Daeuble  
PO Box 352205  
Seattle, Washington 98195  
Telephone: (206) 769-5253

AGENT: Reid Middleton  
Attention: Blaine McRae  
728 134<sup>th</sup> Street Southwest, Suite 200  
Everett, Washington 98204  
Telephone: (425) 290-2721

LOCATION: In Union Bay, near Seattle, King County, Washington

WORK: The University of Washington proposes to renovate facilities at two locations, the Waterfront Activities Center (WAC) and Conibear Shellhouse, along Union Bay, Seattle,

## NWS-2023-705, Washington, University of (WAC & Husky Harbor Dock Improvements)

Washington. Work would be conducted on 10 separate overwater structures, with the replacement of 10,165 square-feet of overwater coverage (to include the reorientation of Montlake Dock, and the addition of two expansion piers along the Outer Dock), removal of thirty-four 6-inch to 12-inch diameter timber and steel piles, and the installation of forty 12-inch to 18-inch steel piles via vibratory and impact hammers. The work would result the removal of 5,075 square feet of overwater coverage. Up to 145 linear feet of bulkhead and 500 square feet of timber boat ramp would be removed, and up to 1500 cubic yards of fill material would be discharged in order to create a 6,215-square foot gravel/sand Kayak Launch. A total of 1,295 cubic yards of fill would be placed waterward of the OHWM to build the kayak beach. Creation of the new beach would result in the conversion of 615 square feet of in-water habitat to upland. Additionally, a 16-foot by 50-foot, 800 square foot concrete boat ramp would be installed at the Conibear Shellhouse, requiring the removal of 430 square feet of Category I Wetland.

Staging and access would be from shore and water. Existing pilings would be removed using a vibratory hammer on a barge. The removed pilings would be disposed of at an approved upland facility. If pilings cannot be fully removed, they would be cut off at mudline level. New pilings would be installed from a barge and would use a vibratory hammer to the maximum extent possible. An impact hammer for pile driving would be used if required due to hard driving conditions. demolition of the existing floats and piles and the installation of the new floats and piles would be performed from a barge-based crane (ie: water-based rather than land-based). The work anticipated to be conducted from the upland / above OHWM would be the demolition of the existing abutments and the installation of new concrete abutments in regard to the floats and piles. For the kayak launch / beach, the concrete curb and material placement is anticipated to be conducted using upland based equipment. The new floats would be fabricated off-site and brought to the site via barge. Once the new floats are brought in and in place, pilings would be driven to secure them in place.

The existing floats would be removed and disposed of at an approved disposal facility. The new boat ramp at Conibear Shellhouse would consist of pre-cast concrete panels fabricated offsite. Boat ramp construction would consist of pre-cast concrete panels placed on a 90 cubic yards of prepared crushed surfacing base course that is underlain with geotextile fabric. Panels would be installed from toe to top of ramp. The vegetation to be removed from Wetland B would be done with either an excavator or backhoe. Wetland B vegetation would be removed with upland based equipment as the vegetation is near/at the shore.

Beach construction would begin with removal of the existing bulkhead and boat ramp. Existing soft sediment would be removed and disposed of at an approved upland location. Beach construction would consist of excavation of soft sediment and then installation of a geotextile fabric, crushed rock/ballast layer, another geotextile fabric layer, and then a sand/gravel beach. Beach construction is anticipated to all be completed by upland based equipment.

### PURPOSE:

The purpose of the project is to improve existing facilities and expand recreational access to Union Bay and Lake Washington.

### ADDITIONAL INFORMATION:

## NWS-2023-705, Washington, University of (WAC & Husky Harbor Dock Improvements)

Copies of this public notice which have been mailed or otherwise physically distributed feature project drawings in black and white. The electronic version features those drawings in color, which we think more accurately communicates the scope of project impacts. To access the electronic version of this public notice, go to the Seattle District's web page at <http://www.nws.usace.army.mil/> and under the heading Open Public Comment Periods select Regulatory Public Notices. Recently-issued public notices are listed in chronological order of the date of issuance. Select and view the listing for this project.

The location of the ordinary high-water mark shown on the project drawings have not yet been verified by the U.S. Army Corps of Engineers (Corps). If the Corps determines the boundaries of the wetland/waters are substantially inaccurate a new public notice may be published.

### MITIGATION:

The applicant proposes the following as mitigation: 915 square feet of debris removal, the planting of willow (*Salix* spp.) and red-osier dogwood (*Cornus sericea*) live stakes along the nearshore of the WAC, and the placement of 5,600 square feet of sediment. Current proposed mitigation is being reviewed by the Corps of Engineers.

ENDANGERED SPECIES: The Endangered Species Act (ESA) requires federal agencies to consult with the National Marine Fisheries Service (NMFS) and/or U.S. Fish and Wildlife Service (USFWS) pursuant to Section 7 of the ESA on all actions that may affect a species listed (or proposed for listing) under the ESA as threatened or endangered or any designated critical habitat.

After receipt of comments from this public notice, the U.S. Army Corps of Engineers will evaluate the potential impacts to proposed and/or listed species and their designated critical habitat.

ESSENTIAL FISH HABITAT: The Magnuson-Stevens Fishery Conservation and Management Act, as amended by the Sustainable Fisheries Act of 1996, requires all Federal agencies to consult with the NMFS on all actions, or proposed actions, permitted, funded, or undertaken by the agency, that may adversely affect Essential Fish Habitat (EFH).

If the U.S. Army Corps of Engineers (Corps) determines that the proposed action may adversely affect EFH for federally managed fisheries in Washington waters, the Corps will initiate EFH consultation with the NMFS. The Corps' final determination relative to project impacts and the need for mitigation measures is subject to review by and coordination with the NMFS.

CULTURAL RESOURCES: The Corps has reviewed the latest published version of the National Register of Historic Places, Washington Information System for Architectural and Archaeological Records Data and other sources of information. Historic properties are recorded near the proposed project. However, they do not occur in the permit area. The proposed work is of such a limited nature and extent that little likelihood exists for the project to impinge upon an unrecorded historic property. The Corps invites responses to this public notice from Native American Nations or tribal governments; Federal, State, and local agencies; historical and

NWS-2023-705, Washington, University of (WAC & Husky Harbor Dock Improvements)

archeological societies; and other parties likely to have knowledge of or concerns regarding historic properties and sites of religious and cultural significance at or near the project area. After receipt of comments from this public notice, the Corps will evaluate potential impacts and consult with the State Historic Preservation Officer and Native American Nations in accordance with Section 106 of the National Historic Preservation Act, as appropriate.

**PUBLIC HEARING:** Any person may request, in writing, within the comment period specified in this notice, that a public hearing be held to consider this application. Requests for public hearings shall state, with particularity, the reasons for holding a public hearing.

**EVALUATION:** The decision whether to issue a permit will be based on an evaluation of the probable impacts, including cumulative impacts, of the proposed activity on the public interest. That decision will reflect the national concern for both protection and utilization of important resources. The benefits, which reasonably may be expected to accrue from the proposal, must be balanced against its reasonably foreseeable detriments. All factors which may be relevant to the proposal will be considered, including the cumulative effects thereof; among those are conservation, economics, aesthetics, general environmental concerns, wetlands, historic properties, fish and wildlife values, flood hazards, floodplain values, land use, navigation, shoreline erosion and accretion, recreation, water supply and conservation, water quality, energy needs, safety, food and fiber production, mineral needs, considerations of property ownership, and, in general, the needs and welfare of the people. The Washington Department of Ecology has or will evaluate the proposed project in accordance with Section 401 of the Clean Water Act and for consistency with the Coastal Zone Management Act.

The U.S. Army Corps of Engineers is soliciting comments from the public; Native American Nations or tribal governments; Federal, State, and local agencies and officials; and other interested parties in order to consider and evaluate the impacts of this activity. Any comments received will be considered by the Corps to determine whether to issue, modify, condition or deny a permit for the work. To make this decision, comments are used to assess impacts on endangered species, historic properties, water quality, general environmental effects, and the other public interest factors listed above. Comments are used in the preparation of an Environmental Assessment and/or an Environmental Impact Statement pursuant to the National Environmental Policy Act. Comments are also used to determine the need for a public hearing and to determine the overall public interest of the activity.

**COMMENT AND REVIEW PERIOD:** Conventional mail or e-mail comments on this public notice will be accepted and made part of the record and will be considered in determining whether authorizing the work would not be contrary to the public interest. In order to be accepted, e-mail comments must originate from the author's e-mail account and must include on the subject line of the e-mail message the permit applicant's name and reference number as shown below. All e-mail comments should be sent to [Trevor.Williams@usace.army.mil](mailto:Trevor.Williams@usace.army.mil). Conventional mail comments should be sent U.S. Army Corps of Engineers, Regulatory Branch, 4735 E. Marginal Way S, Bldg 1202, Seattle, Washington, 98134-2388. Either conventional mail or e-mail comments must include the permit applicant's name and reference number, as shown below, and the commenter's name, address, and phone number. All comments received will become part of the administrative record and are subject to public release under the Freedom of



NWS-2023-705, Washington, University of (WAC & Husky Harbor Dock Improvements)

Information Act including any personally identifiable information such as names, phone numbers, and addresses. All comments whether conventional mail or e-mail must reach this office, no later than the expiration date of this public notice to ensure consideration. Please include the following name and reference number:

University of Washington, NWS-2023-705

Encl: Figures (20)



SHEET INDEX	
SHEET NO.	SHEET DESCRIPTION
1	LOCATION MAP, VICINITY MAP, AND SHEET INDEX
2	PROJECT SITE LOCATIONS PLAN
3	WAC EXISTING WETLAND A
4	CONIBEAR EXISTING WETLAND B
5	WAC EXISTING FLOATS
6	WAC PROPOSED FLOAT REPLACEMENT & BEACH
7	MONTLAKE DOCK PLAN AND ELEVATION
8	LANDING DOCK PLAN AND ELEVATION
9	SOUTH OUTER DOCK PLAN AND ELEVATION
10	NORTH OUTER DOCK PLAN AND ELEVATION
11	WAC BEACH EXISTING CONDITIONS PLAN PLAN
12	WAC BEACH GRADING AND LAYOUT PLAN
13	WAC BEACH CROSS SECTIONS
14	WAC BEACH CROSS SECTIONS
15	CONIBEAR EXISTING BOAT RAMP AND FLOAT
16	CONIBEAR PROPOSED BOAT RAMP AND FLOAT
17	CONIBEAR BOAT RAMP ELEVATION AND CROSS-SECTION
18	SUMMARY OF PROPOSED IMPROVEMENTS
19	SUMMARY OF PROPOSED IMPROVEMENTS
20	SUMMARY OF PROPOSED IMPROVEMENTS

REID MIDDLETON  
CONTACT: WILLY AHN, P.E.  
728 134TH STREET SW, SUITE 200  
EVERETT, WA 98204  
(425) 741-3800

UNIVERSITY OF WASHINGTON  
UW FACILITIES, ASSET MANAGEMENT  
CONTACT: ANNA DAEUBLE  
UW FACILITIES BUILDING BOX 352205  
(206) 769-5253

WAC: 3701 WALLA WALLA ROAD NE  
CONIBEAR: 3826 WALLA WALLA ROAD NE  
SEATTLE WA 98195

LATITUDE: 47° 38' 54"  
LONGITUDE: 122° 17' 55"

NAD83/11 SPCS WASHINGTON NORTH ZONE  
US SURVEY FEET

ELEVATION ARE BASED ON NGS BENCHMARK  
PID A13599, ELEVATION = 28.81 FEET (NAVD 88)

IN: SEATTLE, WA  
AT: UNIVERSITY OF WASHINGTON  
COUNTY OF: KING  
APPLICATION BY: UNIVERSITY OF WASHINGTON  
SHEET 1 OF 20      DATE: AUGUST 2024



PURPOSE: FLOAT REPLACEMENT, BEACH, & BOAT LAUNCH WITH BOARDING FLOAT

DATUM: MLLW 0.0'

ADJACENT PROPERTY OWNERS:  
1. N/A

# PROJECT SITE LOCATIONS PLAN

## UNIVERSITY OF WASHINGTON WAC & HUSKY HARBOR DOCK IMPROVEMENTS

ADDRESS: WAC: 3701 WALLA WALLA ROAD NE  
CONIBEAR: 3826 WALLA WALLA ROAD NE  
SEATTLE WA 98195

**Reid Middleton**

728 134th Street SW · Suite 200  
Everett, Washington 98204  
Ph: 425 741-3800

IN: SEATTLE, WA  
AT: UNIVERSITY OF WASHINGTON  
COUNTY OF: KING  
APPLICATION BY: UNIVERSITY OF WASHINGTON  
SHEET 2 OF 20 DATE: AUGUST 2024



PURPOSE: FLOAT REPLACEMENT, BEACH, & BOAT LAUNCH WITH BOARDING FLOAT

DATUM: MLLW 0.0'

ADJACENT PROPERTY OWNERS:  
1. N/A

# WAC WETLAND BOUNDARY A

## UNIVERSITY OF WASHINGTON WAC & HUSKY HARBOR DOCK IMPROVEMENTS

ADDRESS: WAC: 3701 WALLA WALLA ROAD NE  
CONIBEAR: 3826 WALLA WALLA ROAD NE  
SEATTLE WA 98195

**Reid Middleton**

728 134th Street SW · Suite 200  
Everett, Washington 98204  
Ph: 425 741-3800

IN: SEATTLE, WA  
AT: UNIVERSITY OF WASHINGTON  
COUNTY OF: KING  
APPLICATION BY: UNIVERSITY OF WASHINGTON  
SHEET 3 OF 20 DATE: AUGUST 2024





PURPOSE: FLOAT REPLACEMENT, BEACH, & BOAT LAUNCH WITH BOARDING FLOAT

DATUM: MLLW 0.0'

ADJACENT PROPERTY OWNERS:  
1. N/A

### CONIBEAR WETLAND BOUNDARY B

### UNIVERSITY OF WASHINGTON WAC & HUSKY HARBOR DOCK IMPROVEMENTS

ADDRESS: WAC: 3701 WALLA WALLA ROAD NE  
CONIBEAR: 3826 WALLA WALLA ROAD NE  
SEATTLE WA 98195

**Reid Middleton**

728 134th Street SW · Suite 200  
Everett, Washington 98204  
Ph: 425 741-3800

IN: SEATTLE, WA  
AT: UNIVERSITY OF WASHINGTON  
COUNTY OF: KING  
APPLICATION BY: UNIVERSITY OF WASHINGTON  
SHEET 4 OF 20 DATE: AUGUST 2024





IN: SEATTLE, WA  
AT: UNIVERSITY OF WASHINGTON  
COUNTY OF: KING  
APPLICATION BY: UNIVERSITY OF WASHINGTON  
SHEET 5 OF 20      DATE: AUGUST 2024



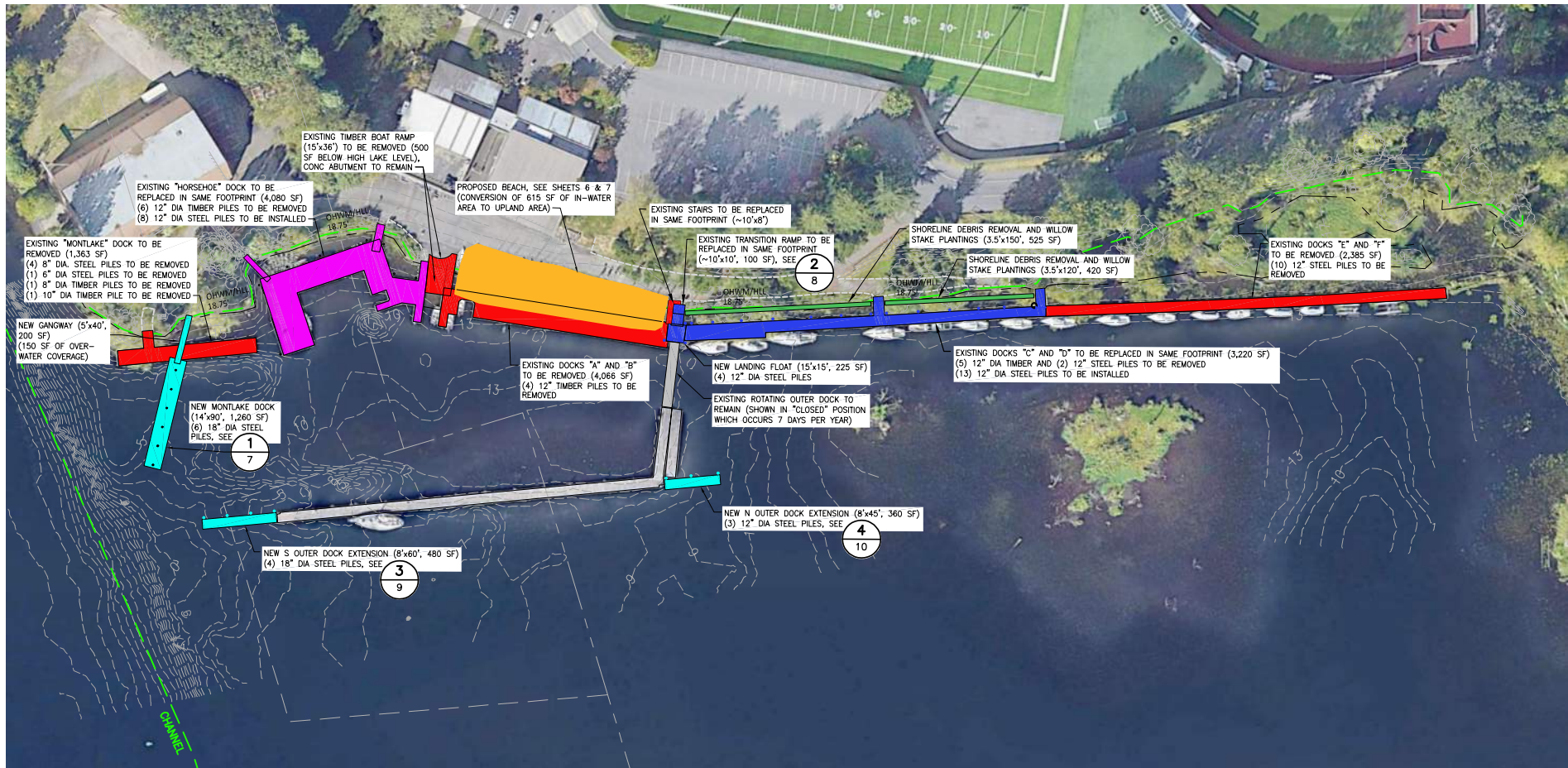

PURPOSE: FLOAT REPLACEMENT, BEACH, & BOAT LAUNCH WITH BOARDING FLOAT

DATUM: MLLW 0.0'

ADJACENT PROPERTY OWNERS:

1. N/A

### WAC PROPOSED FLOAT REPLACEMENT & BEACH

#### UNIVERSITY OF WASHINGTON WAC & HUSKY HARBOR DOCK IMPROVEMENTS

ADDRESS: WAC: 3701 WALLA WALLA ROAD NE  
CONIBEAR: 3826 WALLA WALLA ROAD NE  
SEATTLE WA 98195

**Reid Middleton**

728 134th Street SW · Suite 200  
Everett, Washington 98204  
Ph: 425 741-3800

IN: SEATTLE, WA  
AT: UNIVERSITY OF WASHINGTON  
COUNTY OF: KING  
APPLICATION BY: UNIVERSITY OF WASHINGTON  
SHEET 6 OF 20 DATE: AUGUST 2024

01/31/2025

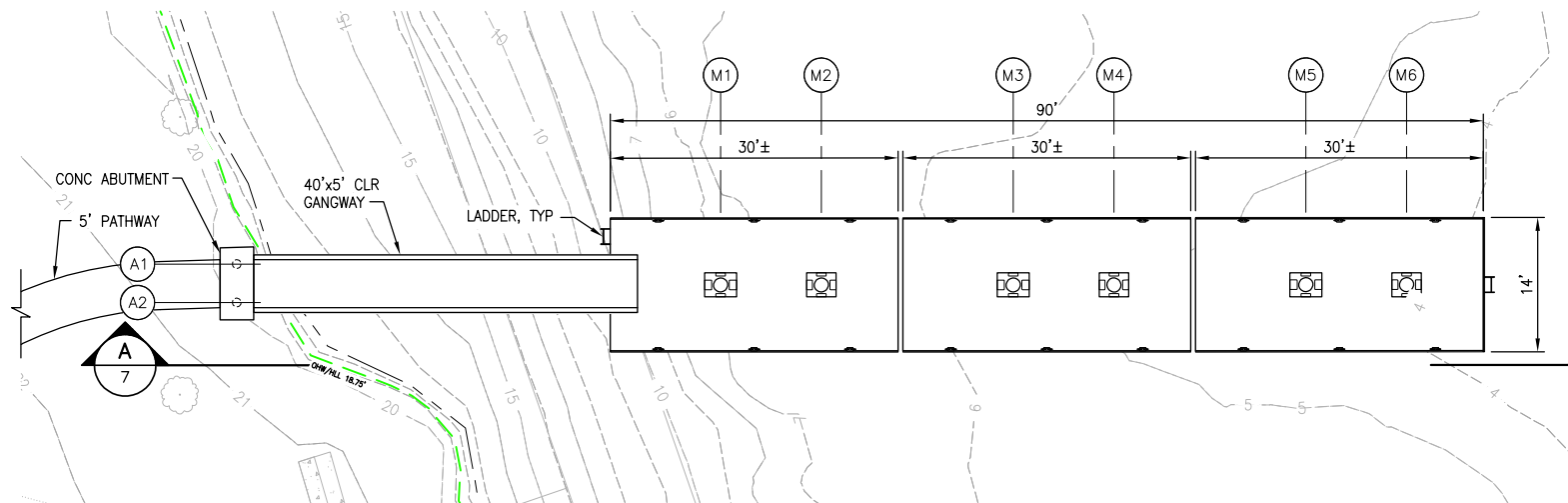

1 MONTLAKE DOCK PLAN  
6 SCALE" 1"=20'

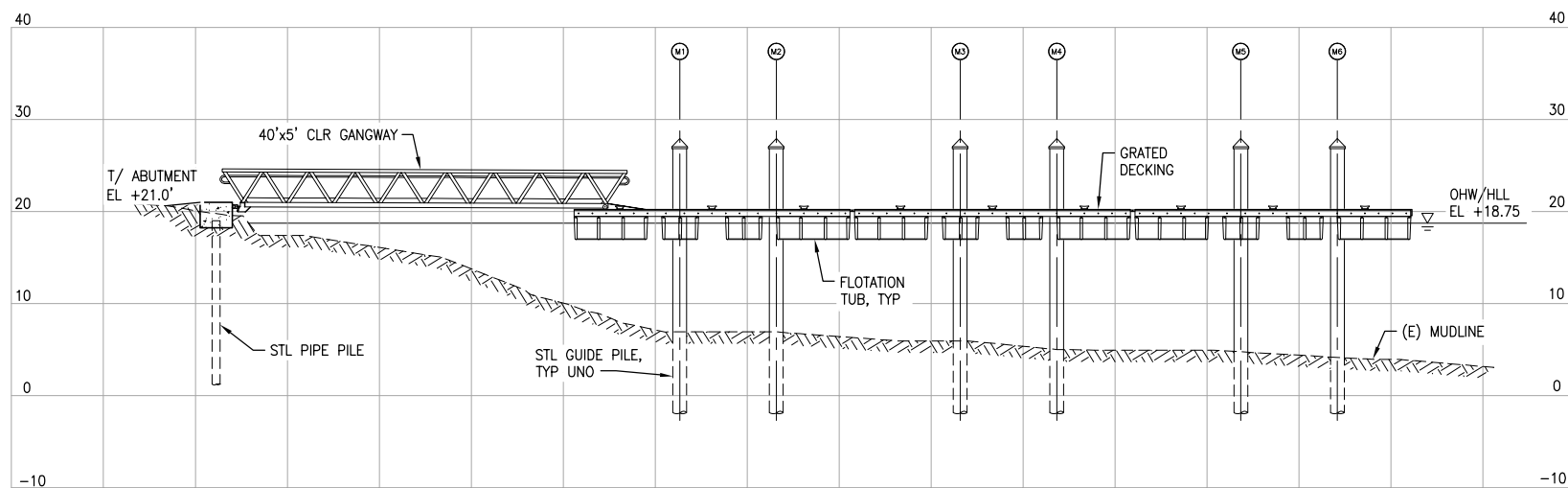

A MONTLAKE DOCK ELEVATION  
7 SCALE" 1"=20'

SCALE IN FEET  
0 20

PURPOSE: FLOAT REPLACEMENT, BEACH, & BOAT LAUNCH WITH BOARDING FLOAT

DATUM: MLLW 0.0'

ADJACENT PROPERTY OWNERS:  
1. N/A

### MONTLAKE DOCK PLAN AND ELEVATION

#### UNIVERSITY OF WASHINGTON WAC & HUSKY HARBOR DOCK IMPROVEMENTS

ADDRESS: WAC: 3701 WALLA WALLA ROAD NE  
CONIBEAR: 3826 WALLA WALLA ROAD NE  
SEATTLE WA 98195

**Reid Middleton**

728 134th Street SW Suite 200  
Everett, Washington 98204  
Ph: 425 741-3800

IN: SEATTLE, WA  
AT: UNIVERSITY OF WASHINGTON  
COUNTY OF: KING  
APPLICATION BY: UNIVERSITY OF WASHINGTON  
SHEET 7 OF 20 DATE: AUGUST 2024



01/31/2025

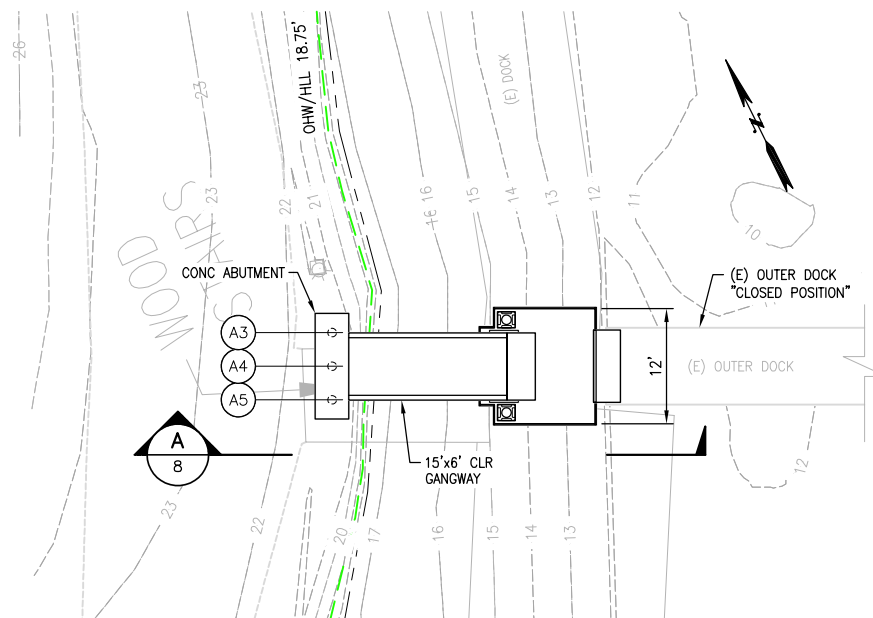

**2** LANDING DOCK PLAN  
6 SCALE" 1"=20'

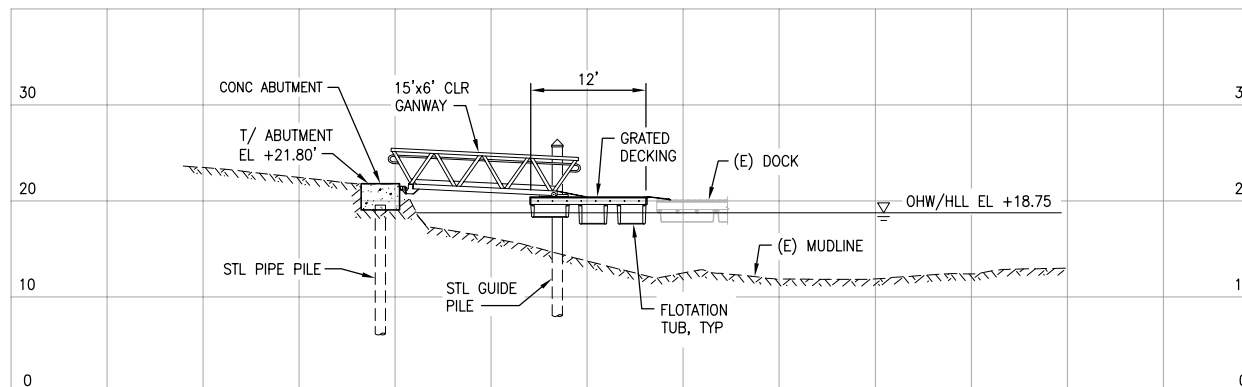

**A** LANDING DOCK ELEVATION  
8 SCALE" 1"=20'

SCALE IN FEET  
0 20

PURPOSE: FLOAT REPLACEMENT, BEACH, & BOAT LAUNCH WITH BOARDING FLOAT

DATUM: MLLW 0.0'

ADJACENT PROPERTY OWNERS:  
1. N/A

## LANDING DOCK PLAN AND ELEVATION

### UNIVERSITY OF WASHINGTON WAC & HUSKY HARBOR DOCK IMPROVEMENTS

ADDRESS: WAC: 3701 WALLA WALLA ROAD NE  
CONIBEAR: 3826 WALLA WALLA ROAD NE  
SEATTLE WA 98195

**Reid Middleton**

728 134th Street SW Suite 200  
Everett, Washington 98204  
Ph: 425 741-3800

IN: SEATTLE, WA  
AT: UNIVERSITY OF WASHINGTON  
COUNTY OF: KING  
APPLICATION BY: UNIVERSITY OF WASHINGTON  
SHEET 8 OF 20 DATE: AUGUST 2024

01/31/2025

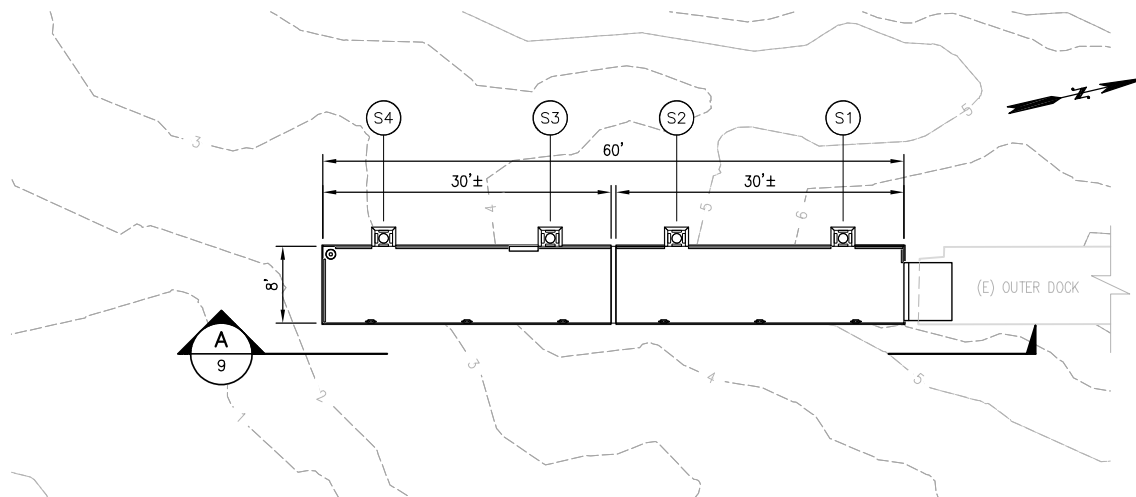

**3** SOUTH OUTER DOCK PLAN  
6 SCALE" 1"=20'

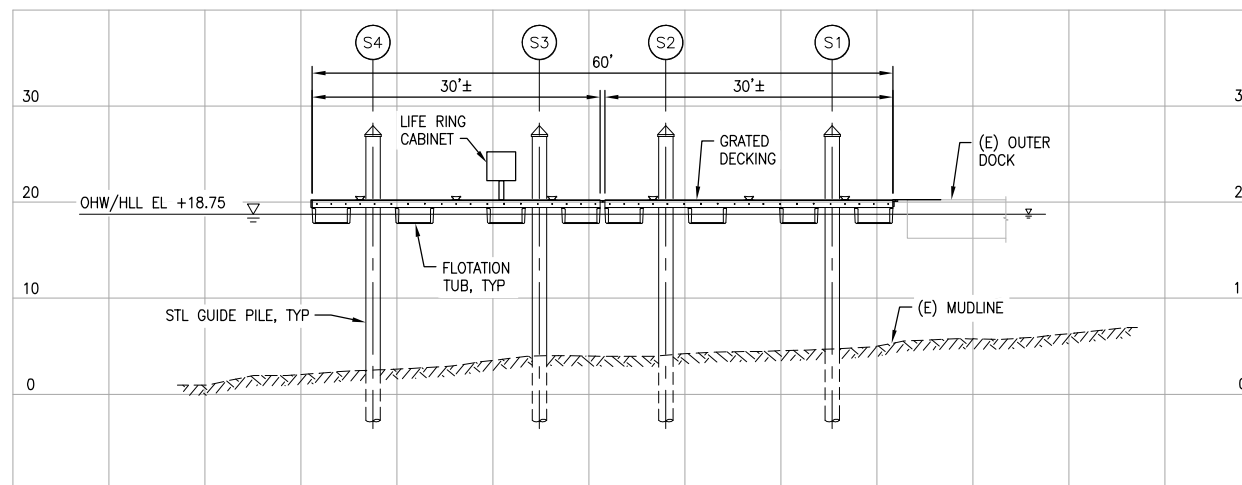

**A** SOUTH OUTER DOCK ELEVATION  
9 SCALE" 1"=20'

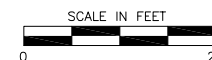

PURPOSE: FLOAT REPLACEMENT, BEACH, & BOAT LAUNCH WITH BOARDING FLOAT

DATUM: MLLW 0.0'

ADJACENT PROPERTY OWNERS:  
1. N/A

### SOUTH OUTER DOCK PLAN AND ELEVATION

**UNIVERSITY OF WASHINGTON  
WAC & HUSKY HARBOR DOCK IMPROVEMENTS**

ADDRESS: WAC: 3701 WALLA WALLA ROAD NE  
CONIBEAR: 3826 WALLA WALLA ROAD NE  
SEATTLE WA 98195

**Reid Middleton**

728 134th Street SW Suite 200  
Everett, Washington 98204  
Ph: 425 741-3800

IN: SEATTLE, WA  
AT: UNIVERSITY OF WASHINGTON  
COUNTY OF: KING  
APPLICATION BY: UNIVERSITY OF WASHINGTON  
SHEET 9 OF 20 DATE: AUGUST 2024

01/31/2025

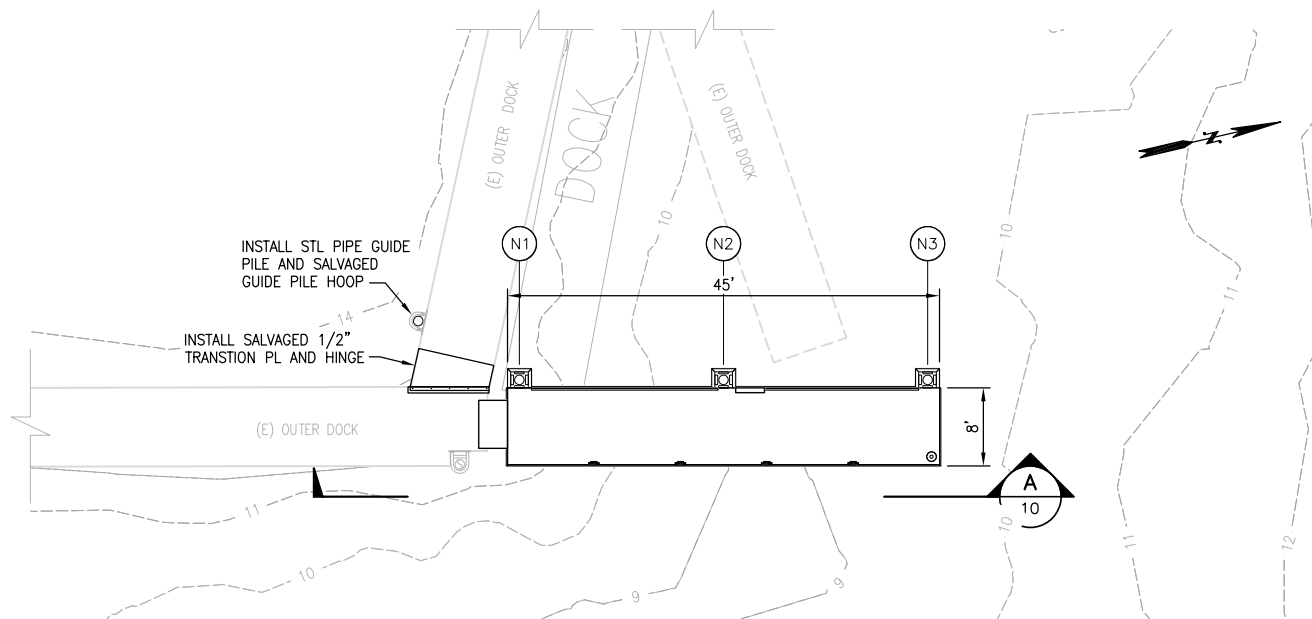

**4 NORTH OUTER DOCK PLAN**  
SCALE" 1"=20'

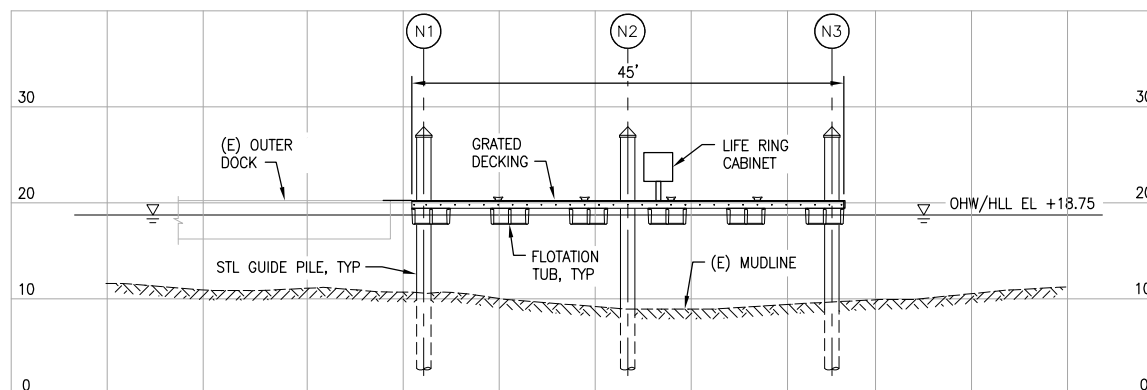

**A NORTH OUTER DOCK ELEVATION**  
SCALE" 1"=20'

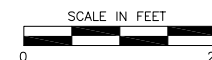

PURPOSE: FLOAT REPLACEMENT, BEACH, & BOAT LAUNCH WITH BOARDING FLOAT

DATUM: MLLW 0.0'

ADJACENT PROPERTY OWNERS:  
1. N/A

# **NORTH OUTER DOCK PLAN AND ELEVATION**

**UNIVERSITY OF WASHINGTON  
WAC & HUSKY HARBOR DOCK IMPROVEMENTS**

ADDRESS: WAC: 3701 WALLA WALLA ROAD NE  
CONIBEAR: 3826 WALLA WALLA ROAD NE  
SEATTLE WA 98195

**Reid Middleton**

728 134th Street SW Suite 200  
Everett, Washington 98204  
Ph: 425 741-3800

IN: SEATTLE, WA  
AT: UNIVERSITY OF WASHINGTON  
COUNTY OF: KING  
APPLICATION BY: UNIVERSITY OF WASHINGTON  
SHEET 10 OF 20 DATE: AUGUST 2024

01/31/2025

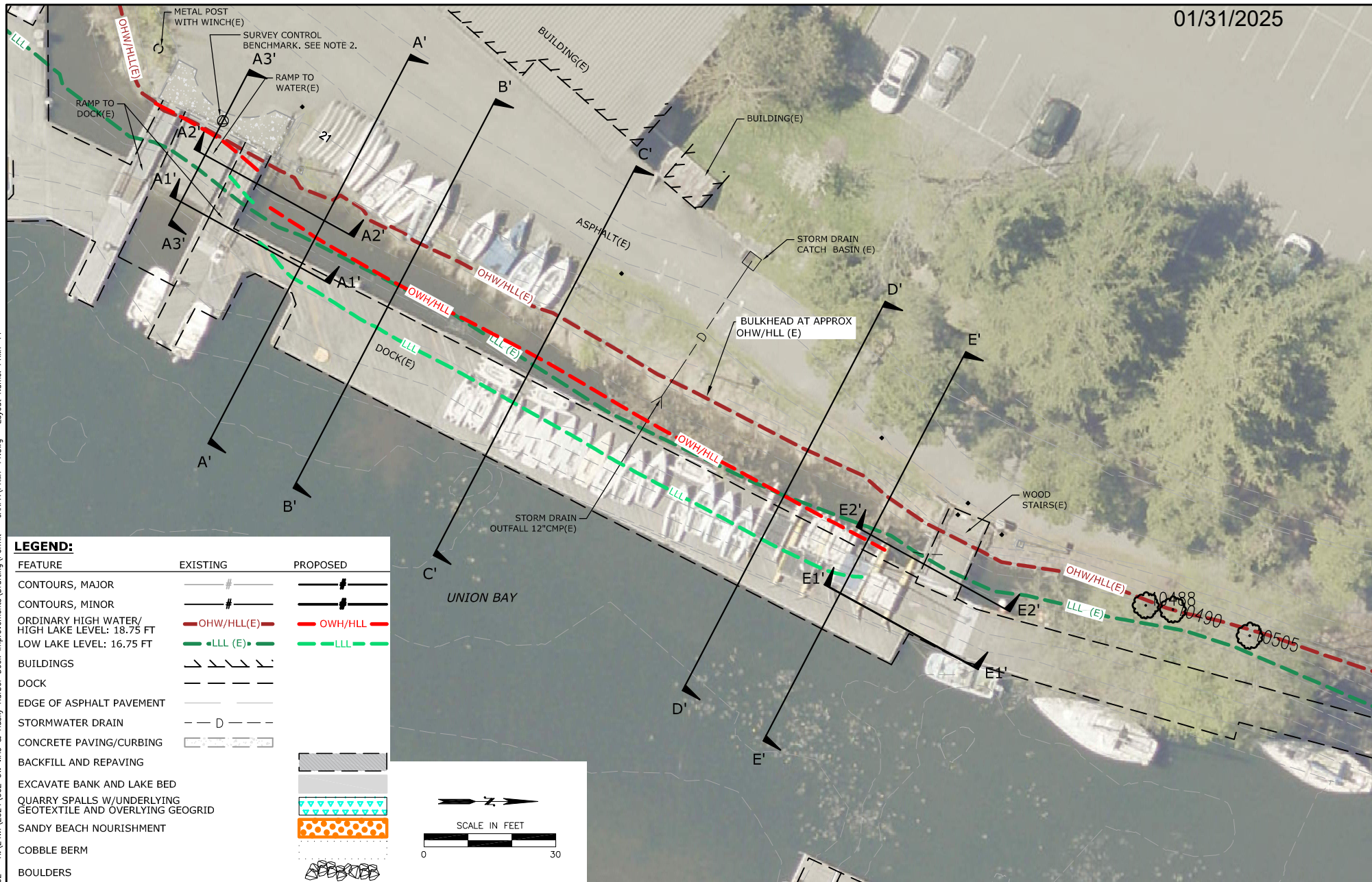

**LEGEND:**

FEATURE	EXISTING	PROPOSED
CONTOURS, MAJOR		
CONTOURS, MINOR		
ORDINARY HIGH WATER/ HIGH LAKE LEVEL: 18.75 FT		
LOW LAKE LEVEL: 16.75 FT		
BUILDINGS		
DOCK		
EDGE OF ASPHALT PAVEMENT		
STORMWATER DRAIN		
CONCRETE PAVING/CURBING		
BACKFILL AND REPAVING		
EXCAVATE BANK AND LAKE BED		
QUARRY SPALLS W/UNDERLYING GEOTEXTILE AND OVERLYING GEOGRID		
SANDY BEACH NOURISHMENT		
COBBLE BERM		
BOULDERS		

PURPOSE: FLOAT REPLACEMENT, BEACH, & BOAT LAUNCH WITH BOARDING FLOAT

DATUM: MLLW 0.0'

ADJACENT PROPERTY OWNERS:  
1. N/A

**WAC BEACH EXISTING CONDITIONS PLAN**

**UNIVERSITY OF WASHINGTON  
WAC & HUSKY HARBOR DOCK IMPROVEMENTS**

ADDRESS: WAC: 3701 WALLA WALLA ROAD NE  
CONIBEAR: 3826 WALLA WALLA ROAD NE  
SEATTLE WA 98195

**Reid Middleton**

728 134th Street SW Suite 200  
Everett, Washington 98204  
Ph: 425 741-3800

IN: SEATTLE, WA  
AT: UNIVERSITY OF WASHINGTON  
COUNTY OF: KING  
APPLICATION BY: UNIVERSITY OF WASHINGTON  
SHEET 11 OF 20 DATE: AUGUST 2024



Aug 31, 2024 - 9:01pm  
H:\24W\2024\002 UW WAC & Husky Harbor Dock Improvements\Drafting\Permit - JARPA\PRMT 12.dwg Layout Name: PRMT 12

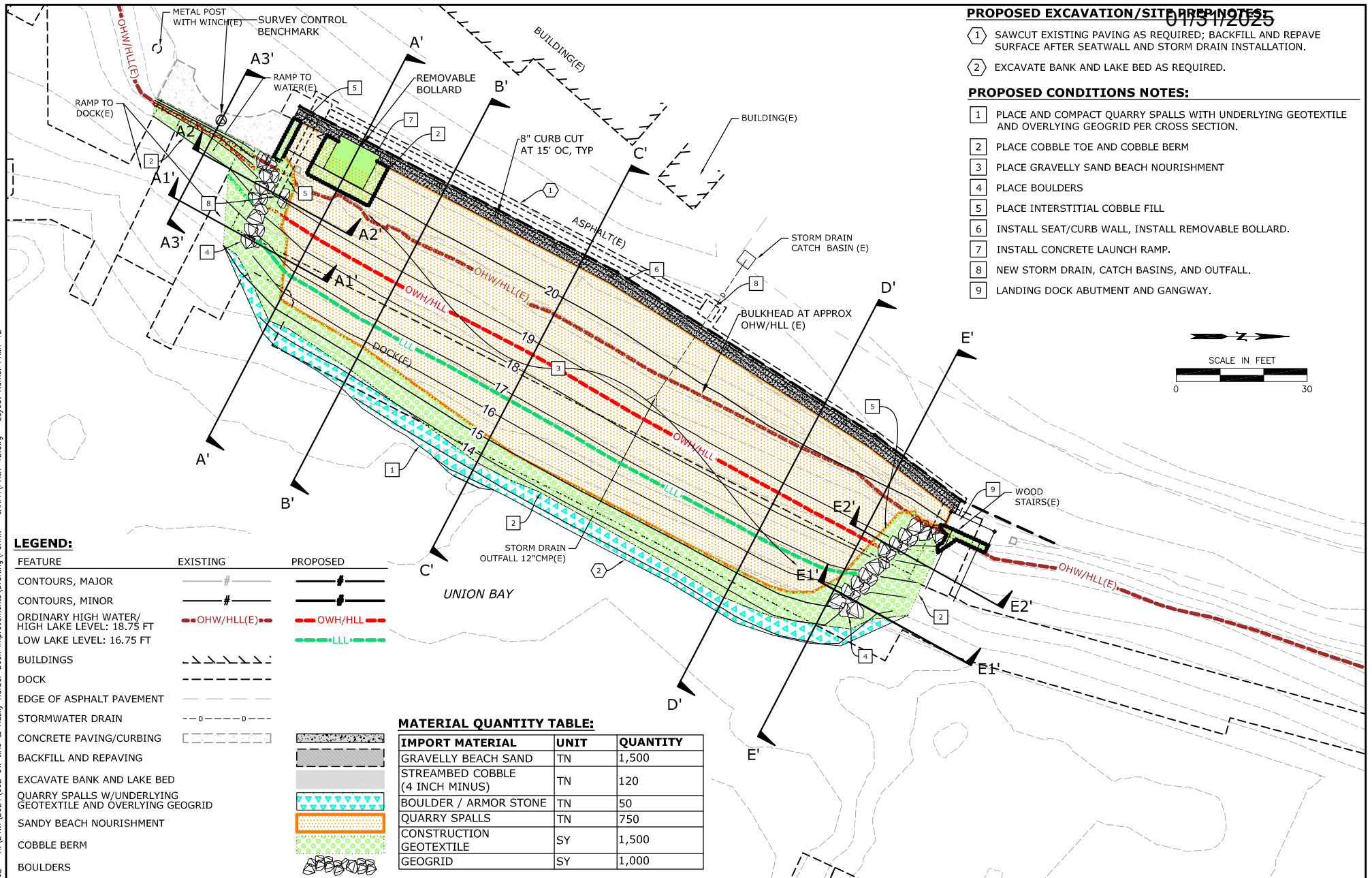

**LEGEND:**

FEATURE	EXISTING	PROPOSED
CONTOURS, MAJOR		
CONTOURS, MINOR		
ORDINARY HIGH WATER/ HIGH LAKE LEVEL: 18.75 FT		
LOW LAKE LEVEL: 16.75 FT		
BUILDINGS		
DOCK		
EDGE OF ASPHALT PAVEMENT		
STORMWATER DRAIN		
CONCRETE PAVING/CURBING		
BACKFILL AND REPAVING		
EXCAVATE BANK AND LAKE BED		
QUARRY SPALLS W/UNDERLYING GEOTEXTILE AND OVERLYING GEOGRID		
SANDY BEACH NOURISHMENT		
COBBLE BERM		
BOULDERS		

**MATERIAL QUANTITY TABLE:**

IMPORT MATERIAL	UNIT	QUANTITY
GRAVELLY BEACH SAND	TN	1,500
STREAMBED COBBLE (4 INCH MINUS)	TN	120
BOULDER / ARMOR STONE	TN	50
QUARRY SPALLS	TN	750
CONSTRUCTION GEOTEXTILE	SY	1,500
GEOGRID	SY	1,000

**PROPOSED EXCAVATION/SITE PREP NOTES:**

- SAWCUT EXISTING PAVING AS REQUIRED; BACKFILL AND REPAVE SURFACE AFTER SEATWALL AND STORM DRAIN INSTALLATION.
- EXCAVATE BANK AND LAKE BED AS REQUIRED.

**PROPOSED CONDITIONS NOTES:**

- PLACE AND COMPACT QUARRY SPALLS WITH UNDERLYING GEOTEXTILE AND OVERLYING GEOGRID PER CROSS SECTION.
- PLACE COBBLE TOE AND COBBLE BERM
- PLACE GRAVELLY SAND BEACH NOURISHMENT
- PLACE BOULDERS
- PLACE INTERSTITIAL COBBLE FILL
- INSTALL SEAT/CURB WALL, INSTALL REMOVABLE BOLLARD.
- INSTALL CONCRETE LAUNCH RAMP.
- NEW STORM DRAIN, CATCH BASINS, AND OUTFALL.
- LANDING DOCK ABUTMENT AND GANGWAY.



PURPOSE: FLOAT REPLACEMENT, BEACH, & BOAT LAUNCH WITH BOARDING FLOAT

DATUM: MLLW 0.0'

ADJACENT PROPERTY OWNERS:  
1. N/A

**WAC BEACH GRADING AND LAYOUT PLAN**

**UNIVERSITY OF WASHINGTON  
WAC & HUSKY HARBOR DOCK IMPROVEMENTS**

ADDRESS: WAC: 3701 WALLA WALLA ROAD NE  
CONIBEAR: 3826 WALLA WALLA ROAD NE  
SEATTLE WA 98195

**Reid Middleton**

728 134th Street SW Suite 200  
Everett, Washington 98204  
Ph: 425 741-3800

IN: SEATTLE, WA  
AT: UNIVERSITY OF WASHINGTON  
COUNTY OF: KING  
APPLICATION BY: UNIVERSITY OF WASHINGTON  
SHEET 12 OF 20 DATE: AUGUST 2024

PROPOSED EXCAVATION/SITE PREP NOTES  
01/31/2025

- 1 SAWCUT EXISTING PAVING AS REQUIRED; BACKFILL AND REPAVE SURFACE AFTER SEATWALL AND STORM DRAIN INSTALLATION.
- 2 EXCAVATE BANK AND LAKE BED AS REQUIRED.

PROPOSED CONDITIONS NOTES:

- 1 PLACE AND COMPACT QUARRY SPALLS WITH UNDERLYING GEOTEXTILE AND OVERLYING GEOGRID.
- 2 PLACE COBBLE TOE AND COBBLE BERM
- 3 PLACE GRAVELLY SAND BEACH NOURISHMENT
- 4 PLACE BOULDERS
- 5 PLACE INTERSTITIAL COBBLE FILL
- 6 INSTALL SEAT/CURB WALL
- 7 INSTALL CONCRETE LAUNCH RAMP AND INSTALL REMOVABLE BOLLARD
- 8 NEW STORM DRAIN, CATCH BASINS, AND OUTFALL

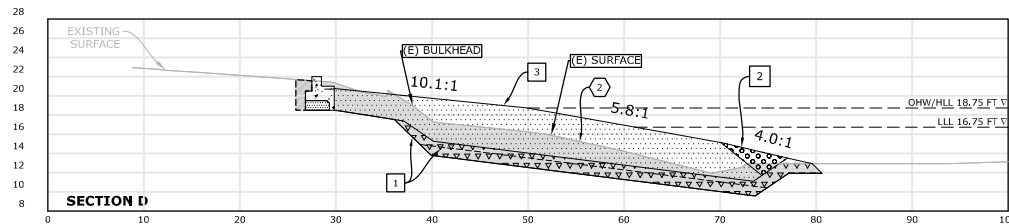
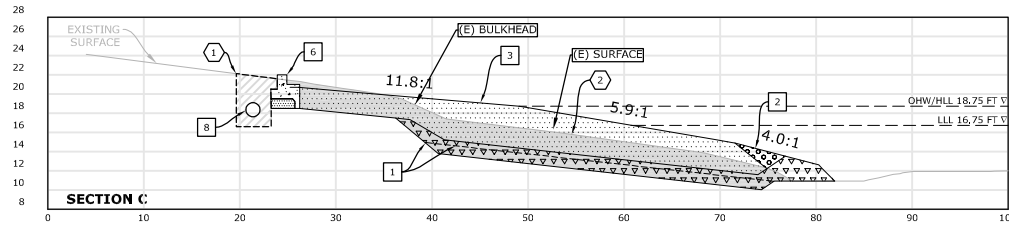
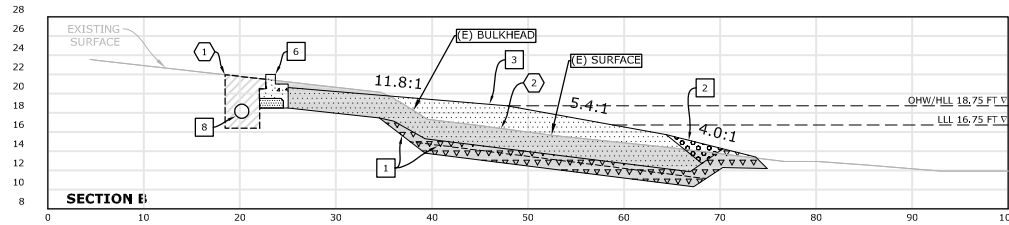
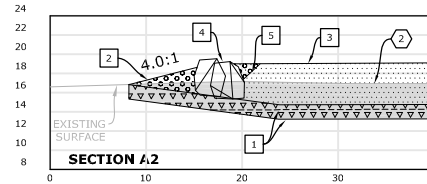
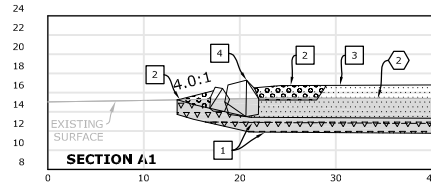
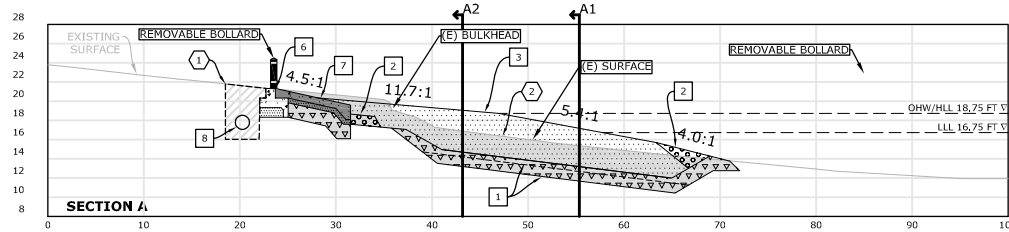

PURPOSE: FLOAT REPLACEMENT, BEACH, & BOAT LAUNCH WITH BOARDING FLOAT

DATUM: MLLW 0.0'

ADJACENT PROPERTY OWNERS:  
1. N/A

WAC BEACH CROSS SECTIONS

UNIVERSITY OF WASHINGTON  
WAC & HUSKY HARBOR DOCK IMPROVEMENTS

ADDRESS: WAC: 3701 WALLA WALLA ROAD NE  
CONIBEAR: 3826 WALLA WALLA ROAD NE  
SEATTLE WA 98195

Reid Middleton

728 134th Street SW · Suite 200  
Everett, Washington 98204  
Ph: 425 741-3800

IN: SEATTLE, WA  
AT: UNIVERSITY OF WASHINGTON  
COUNTY OF: KING  
APPLICATION BY: UNIVERSITY OF WASHINGTON  
SHEET 13 OF 20 DATE: AUGUST 2024

Sep 03, 2024 - 10:24am bigmc924 H:\24M\2024\002 UW WAC & Husky Harbor Dock Improvements\Drafting\Permit - JARPA\PRMT 14.dwg Layout Name: PRMT 14

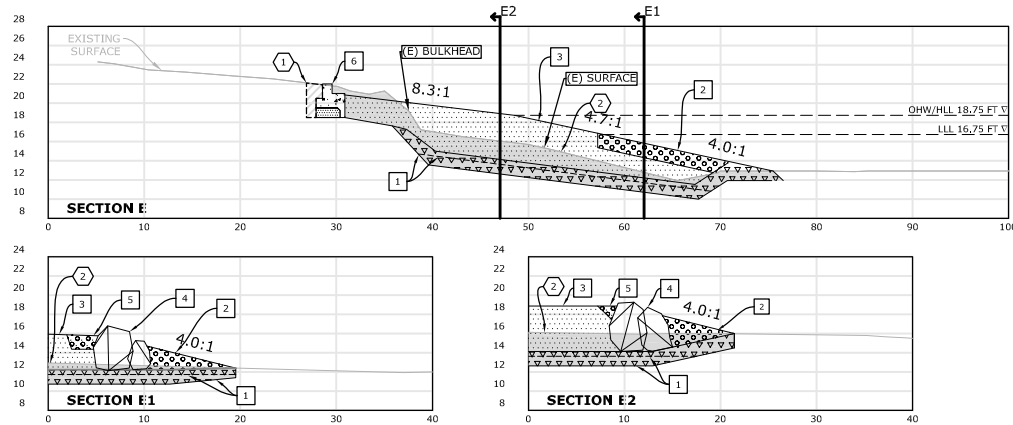

## PROPOSED EXCAVATION/SITE PREP NOTES

- 1 SAWCUT EXISTING PAVING AS REQUIRED; BACKFILL AND REPAVE SURFACE AFTER SEATWALL AND STORM DRAIN INSTALLATION.
- 2 EXCAVATE BANK AND LAKE BED AS REQUIRED.

## PROPOSED CONDITIONS NOTES:

- 1 PLACE AND COMPACT QUARRY SPALLS WITH UNDERLYING GEOTEXTILE AND OVERLYING GEOGRID.
- 2 PLACE COBBLE TOE AND COBBLE BERM
- 3 PLACE GRAVELLY SAND BEACH NOURISHMENT
- 4 PLACE BOULDERS
- 5 PLACE INTERSTITIAL COBBLE FILL
- 6 INSTALL SEAT/CURB WALL
- 7 INSTALL CONCRETE LAUNCH RAMP AND INSTALL REMOVABLE BOLLARD
- 8 NEW STORM DRAIN, CATCH BASINS, AND OUTFALL

PURPOSE: FLOAT REPLACEMENT, BEACH, & BOAT LAUNCH WITH BOARDING FLOAT

DATUM: MLLW 0.0'

ADJACENT PROPERTY OWNERS:  
1. N/A

### WAC BEACH CROSS SECTIONS

#### UNIVERSITY OF WASHINGTON WAC & HUSKY HARBOR DOCK IMPROVEMENTS

ADDRESS: WAC: 3701 WALLA WALLA ROAD NE  
CONIBEAR: 3826 WALLA WALLA ROAD NE  
SEATTLE WA 98195

**Reid Middleton**

728 134th Street SW · Suite 200  
Everett, Washington 98204  
Ph: 425 741-3800

IN: SEATTLE, WA  
AT: UNIVERSITY OF WASHINGTON  
COUNTY OF: KING  
APPLICATION BY: UNIVERSITY OF WASHINGTON  
SHEET 14 OF 20 DATE: AUGUST 2024



PURPOSE: FLOAT REPLACEMENT, BEACH, & BOAT LAUNCH WITH BOARDING FLOAT

DATUM: MLLW 0.0'

ADJACENT PROPERTY OWNERS:  
1. N/A

# CONIBEAR EXISTING BOAT RAMP AND FLOAT

## UNIVERSITY OF WASHINGTON WAC & HUSKY HARBOR DOCK IMPROVEMENTS

ADDRESS: WAC: 3701 WALLA WALLA ROAD NE  
CONIBEAR: 3826 WALLA WALLA ROAD NE  
SEATTLE WA 98195

**Reid Middleton**

728 134th Street SW · Suite 200  
Everett, Washington 98204  
Ph: 425 741-3800

IN: SEATTLE, WA  
AT: UNIVERSITY OF WASHINGTON  
COUNTY OF: KING  
APPLICATION BY: UNIVERSITY OF WASHINGTON  
SHEET 15 OF 20      DATE: AUGUST 2024





PURPOSE: FLOAT REPLACEMENT, BEACH, & BOAT LAUNCH WITH BOARDING FLOAT

DATUM: MLLW 0.0'

ADJACENT PROPERTY OWNERS:  
1. N/A

### CONIBEAR PROPOSED BOAT RAMP AND FLOAT

#### UNIVERSITY OF WASHINGTON WAC & HUSKY HARBOR DOCK IMPROVEMENTS

ADDRESS: WAC: 3701 WALLA WALLA ROAD NE  
CONIBEAR: 3826 WALLA WALLA ROAD NE  
SEATTLE WA 98195

**Reid Middleton**

728 134th Street SW · Suite 200  
Everett, Washington 98204  
Ph: 425 741-3800

IN: SEATTLE, WA  
AT: UNIVERSITY OF WASHINGTON  
COUNTY OF: KING  
APPLICATION BY: UNIVERSITY OF WASHINGTON  
SHEET 16 OF 20 DATE: AUGUST 2024

01/31/2025

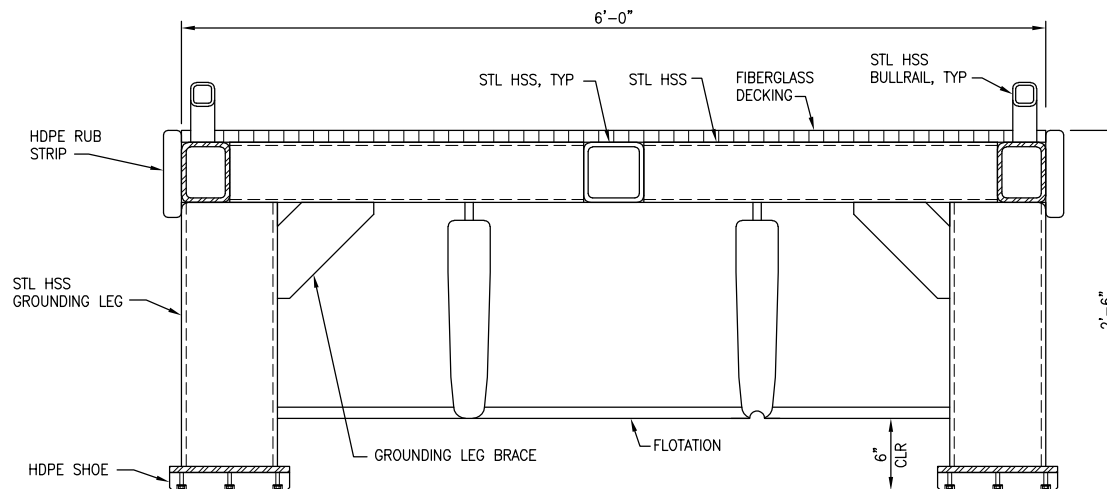

### TYPICAL BOAT RAMP FLOAT SECTION

SCALE: NOT TO SCALE

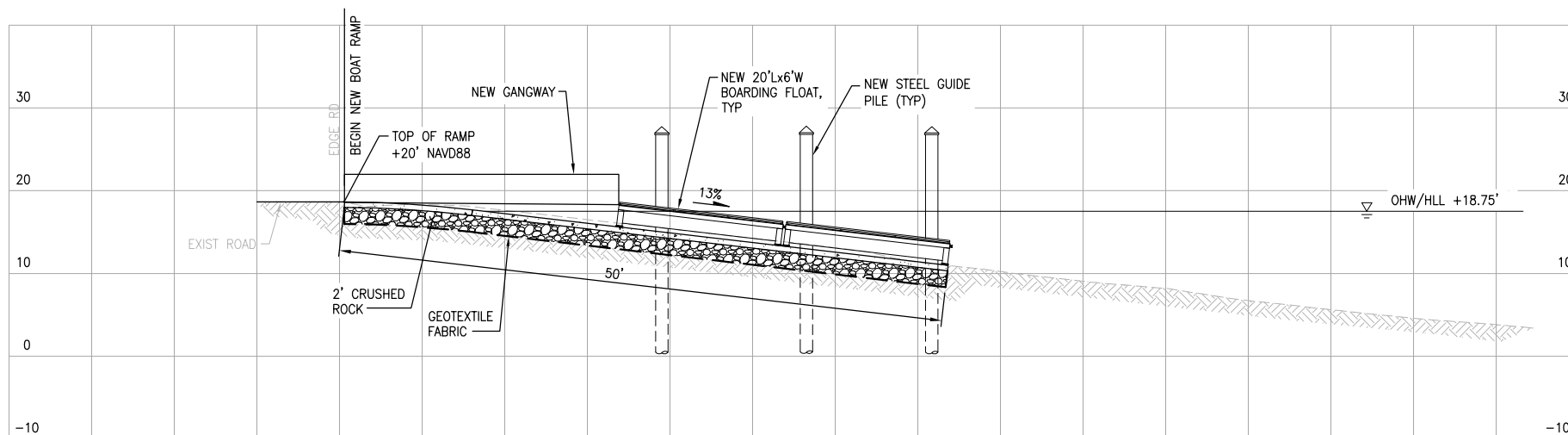

### ELEVATION-PROPOSED BOAT RAMP AND BOARDING FLOATS

SCALE: 1"=20'

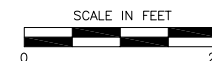

PURPOSE: FLOAT REPLACEMENT, BEACH, & BOAT LAUNCH WITH BOARDING FLOAT

DATUM: MLLW 0.0'

ADJACENT PROPERTY OWNERS:  
1. N/A

### CONIBEAR BOAT RAMP ELEVATION AND CROSS-SECTION

#### UNIVERSITY OF WASHINGTON WAC & HUSKY HARBOR DOCK IMPROVEMENTS

ADDRESS: WAC: 3701 WALLA WALLA ROAD NE  
CONIBEAR: 3826 WALLA WALLA ROAD NE  
SEATTLE WA 98195

**Reid Middleton**

728 134th Street SW Suite 200  
Everett, Washington 98204  
Ph: 425 741-3800

IN: SEATTLE, WA  
AT: UNIVERSITY OF WASHINGTON  
COUNTY OF: KING  
APPLICATION BY: UNIVERSITY OF WASHINGTON  
SHEET 17 OF 20 DATE: AUGUST 2024

Dock Name	Existing Structure		Proposed Structure		"Net Change (Square Feet)"
	Material	Square Feet	Material	Square Feet	
WAC-Montlake Dock	Solid Wood Float	1,363	Grated Decking Gangway and Float	1,410	47
WAC-Horseshoe Dock	Solid Wood Float	4,080	Grated Decking Float	4,080	0
WAC-"A" Dock	Solid Wood Float	1,369	Removal of Dock	0	-1,369
WAC-"B" Dock	Solid Wood Float	2,697	Removal of Dock	0	-2,697
WAC-"C" Dock	Solid Wood Float	1,920	Grated Decking Float	1,920	0
WAC-"D" Dock	Solid Wood Float	805	Grated Decking Float	805	0
WAC-"E" Dock	Solid Wood	1,515	Grated Decking Float	495	-1,020
WAC-"F" Dock	Solid Wood	1,365	Removal of Dock	0	-1,365
Landing Float & Transition Ramp	Solid Wood	Included in B Dock	Grated Decking Ramp and Float	325	325
WAC-Outer Dock Extensions	N/A	0	Grated Decking Float	840	840
Conibear shellhouse dock	Solid Wood Decking	126	Grated Decking Gangway and Float	290	164
Total Overwater Coverage		15,240		10,165	-5,075

PURPOSE: FLOAT REPLACEMENT, BEACH, & BOAT LAUNCH WITH BOARDING FLOAT

DATUM: MLLW 0.0'

ADJACENT PROPERTY OWNERS:  
1. N/A

SUMMARY OF PROPOSED IMPROVEMENTS

UNIVERSITY OF WASHINGTON  
WAC & HUSKY HARBOR DOCK IMPROVEMENTS

ADDRESS: WAC: 3701 WALLA WALLA ROAD NE  
CONIBEAR: 3826 WALLA WALLA ROAD NE  
SEATTLE WA 98195

Reid Middleton

728 134th Street SW Suite 200  
Everett, Washington 98204  
Ph: 425 741-3800

IN: SEATTLE, WA  
AT: UNIVERSITY OF WASHINGTON  
COUNTY OF: KING  
APPLICATION BY: UNIVERSITY OF WASHINGTON  
SHEET 18 OF 20      DATE: AUGUST 2024

Dock Name	Existing Pilings				Proposed Pilings				Net Change	
	Material	Quantity	"Diameter (inches)"	"Area (square feet)"	Material	Quantity	"Diameter (inches)"	"Area (square feet)"	# pilings	"Area (square feet)"
WAC-Montlake Dock	steel	4	8	1.40	steel	6	18	10.60	-1	8.12
	steel	1	6	0.20						
	timber	1	8	0.35						
	timber	1	10	0.55						
WAC-Horseshoe Dock	timber	6	12	4.71	steel	8	12	6.28	2	1.57
WAC-"A" Dock	timber	3	12	2.36		0		0.00	-3	-2.36
WAC-"B" Dock	timber	1	12	0.79		0		0.00	-1	-0.79
WAC-"C" Dock	timber	3	12	2.36	steel	8	12	6.28	4	3.43
	steel	1	9.5	0.49						
WAC-"D" Dock	timber	2	12	1.57	steel	5	12	3.93	2	2.15
	steel C-channel	1	12	0.21						
WAC-"E" Dock	steel	1	12	0.79		0		0.00	-2	-0.99
	steel C-channel	1	12	0.21						
WAC-"F" Dock	steel C-channel	8	12	1.67		0		0.00	-8	-1.67
Landing Float & Transition Ramp	Included in B Dock				steel	4	12	3.14	4	3.14
WAC-Outer Dock Extensions	N/A	0		0.00	steel	3	12	2.36	3	2.36
	N/A	0		0.00	steel	4	18	7.07	4	7.07
Conibear Shellhouse Dock	N/A	0		0.00	steel	3	18	5.30	3	5.30
Totals		34		17.63		40		44.96	3	27.33

PURPOSE: FLOAT REPLACEMENT, BEACH, & BOAT LAUNCH WITH BOARDING FLOAT

DATUM: MLLW 0.0'

ADJACENT PROPERTY OWNERS:  
1. N/A

SUMMARY OF PROPOSED IMPROVEMENTS

UNIVERSITY OF WASHINGTON  
WAC & HUSKY HARBOR DOCK IMPROVEMENTS

ADDRESS: WAC: 3701 WALLA WALLA ROAD NE  
CONIBEAR: 3826 WALLA WALLA ROAD NE  
SEATTLE WA 98195

Reid Middleton

728 134th Street SW · Suite 200  
Everett, Washington 98204  
Ph: 425 741-3800

IN: SEATTLE, WA  
AT: UNIVERSITY OF WASHINGTON  
COUNTY OF: KING  
APPLICATION BY: UNIVERSITY OF WASHINGTON  
SHEET 19 OF 20     DATE: AUGUST 2024

Boat Ramps/Bulkheads	Existing Structure		Proposed Structure		"Net Change (Square Feet)"
	Material	Square Feet	Material	Square Feet	
WAC Boat Ramp	Solid wood	500	None (existing to be removed)	0	-500
WAC Bulkhead (145 linear feet x 3 feet width)	Rock/Concrete Rubble	435	None (existing to be removed for creation of beach)	0	-435
WAC Canoe Launch Beach* (*Additional fill below High Lake Level for substrate enhancement of ~5,600 SF is not included)	None Existing	0	Sand/Gravel placed in-water (conversion from in-water to above)	615	615
Conibear Boat Ramp	None Existing	0.00	Concrete	800	800
<b>Totals</b>		<b>935</b>		<b>1,415</b>	<b>480</b>

Summary	
Overwater coverage	-5,075
Pilings	27.33
Boat Ramps/Bulkheads	480
Overall structures over/in water	-4,568

PURPOSE: FLOAT REPLACEMENT, BEACH, & BOAT LAUNCH WITH BOARDING FLOAT

DATUM: MLLW 0.0'

ADJACENT PROPERTY OWNERS:  
1. N/A

#### SUMMARY OF PROPOSED IMPROVEMENTS

#### UNIVERSITY OF WASHINGTON WAC & HUSKY HARBOR DOCK IMPROVEMENTS

ADDRESS: WAC: 3701 WALLA WALLA ROAD NE  
CONIBEAR: 3826 WALLA WALLA ROAD NE  
SEATTLE WA 98195

**Reid Middleton**

728 134th Street SW · Suite 200  
Everett, Washington 98204  
Ph: 425 741-3800

IN: SEATTLE, WA  
AT: UNIVERSITY OF WASHINGTON  
COUNTY OF: KING  
APPLICATION BY: UNIVERSITY OF WASHINGTON  
SHEET 20 OF 20 DATE: AUGUST 2024